

**This electronic collection of documents is provided  
for the convenience of the user  
and is Not a Certified Document –**

**The documents contained herein were originally issued  
and sealed by the individuals whose names and license  
numbers appear on each page, on the dates appearing  
with their signature on that page.**

**This file or an individual page  
shall not be considered a certified document.**

CONTRACT:DN00706 TIP PROJECT: N/A

CONTRACT:DN00706

# TRANSYLVANIA COUNTY

PROJECT REFERENCE NO.		SHEET NO.
2020CP1.14.07.10881		
STATE PROJECT	F.A. PROJECT NO.	DESCRIPTION

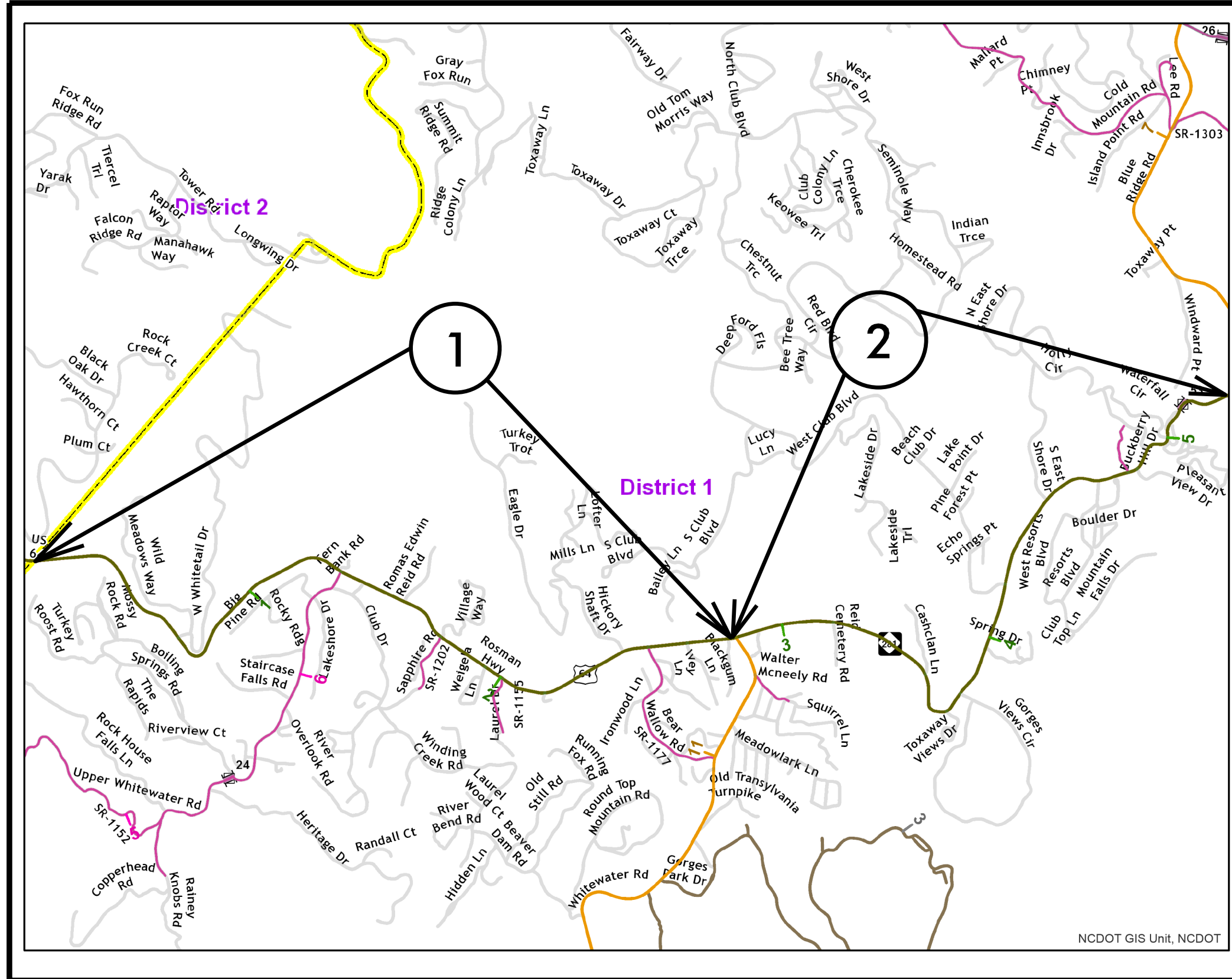

## MAP 1



### BEG

### END

## MAP 2



### BEG

### END

PROJECT REFERENCE NO.		SHEET NO.
2020CPT 14.07.10881		2
STATE PROJECT	F.A. PROJECT NO.	DESCRIPTION
		DN00706

# TYPICAL 1

## SURFACING SCHEDULE

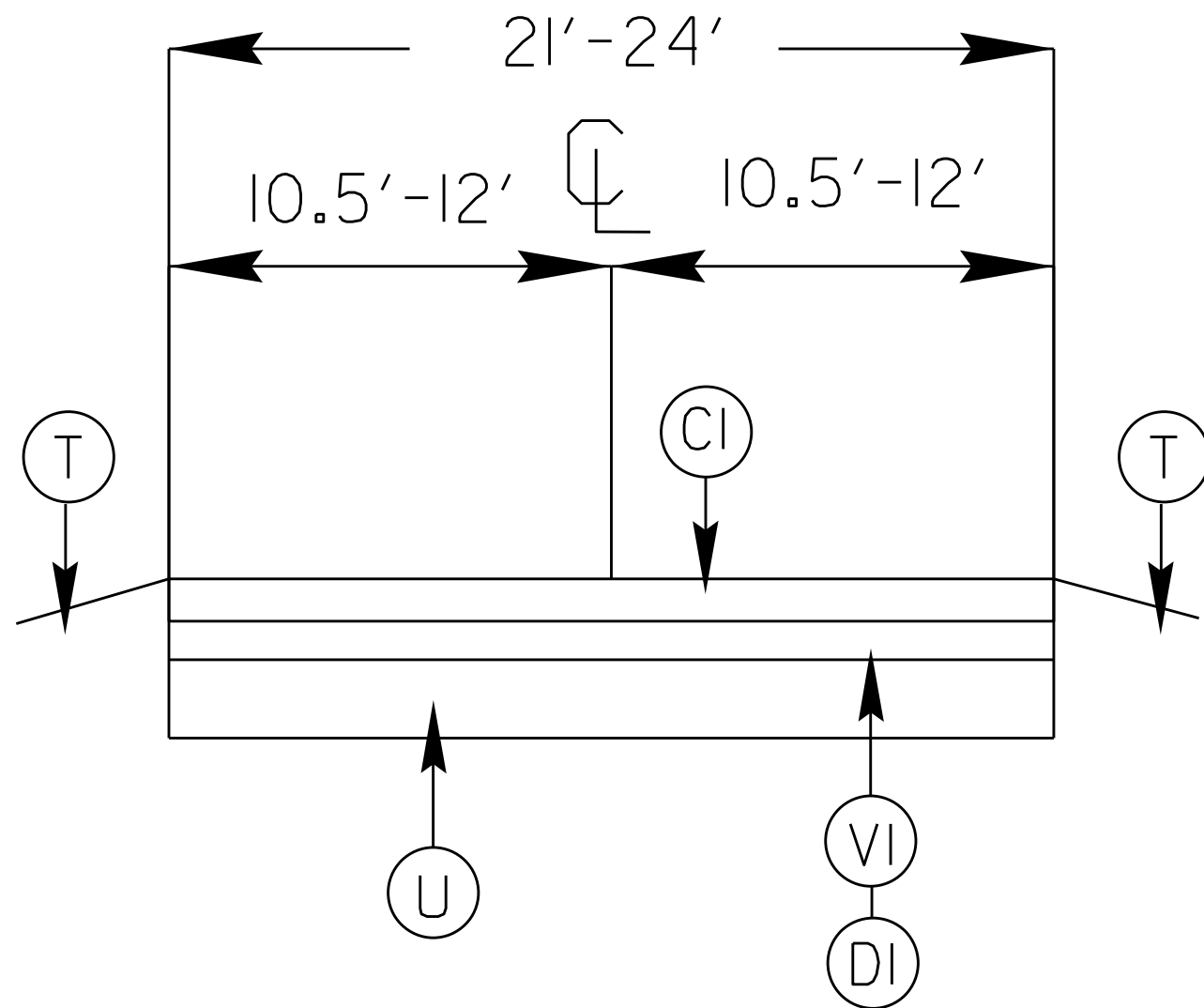

ITEM NO	DESCRIPTION
C1	PROP. APPROX. 1 1/2" ASPHALT CONCRETE SURFACE COURSE, TYPE S9.5C AT AN AVERAGE RATE OF 168 LBS.PER.SQ.YD
D1	PROP. APPROX. 3" ASPHALT CONCRETE INTERMEDIATE COURSE, TYPE I19.OC AT AN AVERAGE RATE OF 342 LBS.PER.SQ.YD
T	SHOULDER RECONSTRUCTION WITH ABCM SEE PROJECT SPECIAL PROVISIONS
U	EXISTING ASPHALT
VI	MILLED ASPHALT PAVEMENT 3" IN DEPTH IN LOCATIONS AS DIRECTED BY PROJECT ENGINEER IN AREAS OF DISTRESS

PROJECT NO.	SHEET NO.	TOTAL NO.
2020CPT.14.07.10881		3

## SUMMARY OF QUANTITIES

PROJECT NO	COUNTY	MAP NO	ROUTE	DESCRIPTION	TYP NO	LANES	LANE TYPE	FINAL SURFACE TESTING REQUIRED	WARM MIX ASPHALT REQUIRED	LENGTH	WIDTH	1245000000-E	1297000000-E	1503000000-E	1523000000-E	1575000000-E	
												SHOULDER RECONSTRUCTION	3" MILLING	INTERMEDIATE COURSE, I19.0C	SURFACE COURSE, S9.5C	ASPHALT BINDER FOR PLANT MIX	
											MI	FT	SMI	SY	TONS	TONS	TONS
2020CPT.14.07.10881	Transylvania	1	US-64	FROM JACKSON CL TO NC-281	1	2	2WU	NO	NO	2.83	21	5.66	36,652	6,516	3,041	495	
<b>TOTAL FOR MAP NO. 1</b>										<b>2.83</b>		<b>5.66</b>	<b>36,652</b>	<b>6,516</b>	<b>3,041</b>	<b>495</b>	
2020CPT.14.07.10881	Transylvania	2	US-64	FROM NC-281 TO BRIDGE #53 (MCNEELY BRIDGE)	1	2		NO	NO	2.34	24	4.68	35,781	6,148	3,238	489	
<b>TOTAL FOR MAP NO. 2</b>										<b>2.34</b>		<b>4.68</b>	<b>35,781</b>	<b>6,148</b>	<b>3,238</b>	<b>489</b>	
<b>TOTAL FOR PROJ NO. 2020CPT.14.07.10881</b>										<b>5.17</b>		<b>10.34</b>	<b>72,433</b>	<b>12,664</b>	<b>6,279</b>	<b>984</b>	
<b>GRAND TOTAL</b>										<b>5.17</b>		<b>10.34</b>	<b>72,433</b>	<b>12,664</b>	<b>6,279</b>	<b>984</b>	

## THERMOPLASTIC AND PAINT QUANTITIES

PROJECT NO	COUNTY	MAP NO	ROUTE	DESCRIPTION	TYP NO	LANES	LANE TYPE	LENGTH	WIDTH	413000000-E	4457000000-N	4700000000-E	4710000000-E	4810000000-E		4825000000-E	4835000000-E	4890000000-E		4905000000-N		
										WORK ZONE ADVANCE/GENERAL WARNING SIGNING	TEMPORARY TRAFFIC CONTROL	12" X 90 M WHITE THERMO	24" X 120 M WHITE THERMO	4" WHITE PAINT	4" YELLOW PAINT	12" WHITE PAINT	24" WHITE PAINT	GENERIC PAVE. MARK ITEM 4" X 60 MIL WHITE THERMO	GENERIC PAVE. MARK ITEM 4" X 60 MIL YELLOW THERMO.	SNOW PLOWABLE MARKERS		
											MI	FT	SF	LS	LF	LF	LF	LF	LF	LF	EA	
2020CPT.14.07.10881	Transylvania	1	US-64	FROM JACKSON CL TO NC-281	1	2	2WU	2.83	21	317	1.00	88	33	30,000	30,000	88	33	60,000	60,000	187		
<b>TOTAL FOR MAP NO. 1</b>										<b>2.83</b>		<b>317</b>	<b>1</b>	<b>88</b>	<b>33</b>	<b>30,000</b>	<b>30,000</b>	<b>88</b>	<b>33</b>	<b>60,000</b>	<b>60,000</b>	<b>187</b>
2020CPT.14.07.10881	Transylvania	2	US-64	FROM NC-281 TO BRIDGE #53 (MCNEELY BRIDGE)	1	2		2.34	24	262			19	24,710	24,710		19	24,710	24,710	154		
<b>TOTAL FOR MAP NO. 2</b>										<b>2.34</b>		<b>262</b>		<b>19</b>	<b>24,710</b>	<b>24,710</b>	<b>19</b>	<b>24,710</b>	<b>24,710</b>	<b>154</b>		
<b>TOTAL FOR PROJ NO. 2020CPT.14.07.10881</b>										<b>5.17</b>		<b>579</b>	<b>1</b>	<b>88</b>	<b>52</b>	<b>54,710</b>	<b>54,710</b>	<b>88</b>	<b>52</b>	<b>84,710</b>	<b>84,710</b>	<b>341</b>
<b>GRAND TOTAL</b>										<b>5.17</b>		<b>579</b>	<b>1</b>	<b>88</b>	<b>52</b>	<b>54,710</b>	<b>54,710</b>	<b>88</b>	<b>52</b>	<b>84,710</b>	<b>84,710</b>	<b>341</b>

# SIGNING FOR RESURFACING PROJECTS

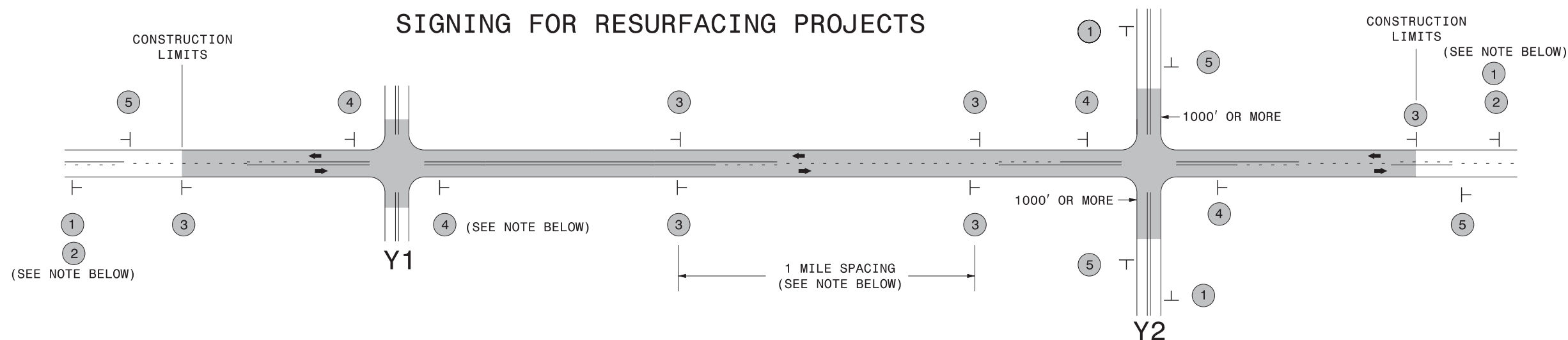

LEGEND	
	STATIONARY SIGN
←	DIRECTION OF TRAFFIC FLOW

## MAINLINE (-L-) SIGNING

## -Y- LINE SIGNING

SIGNING NOTES AND PLACEMENT PER DIRECTION	1	 PLACE 1000' PRIOR TO BEGINNING OF CONSTRUCTION LIMITS. ONLY USED ON -Y- LINES IF RESURFACING LIMITS EXTEND 1000' ALONG -Y- LINE. #2 SIGN ONLY USED WHEN RESURFACING LIMITS ARE 2 OR MORE MILES IN LENGTH. ROUND UP TO NEXT WHOLE NUMBER. (NO FRACTIONAL OR DECIMAL NUMBERS)	NO REQUIRED STATIONARY SIGNING FOR THE FOLLOWING -Y- LINE CONDITIONS:	
	2	 #2 SIGN ONLY USED WHEN RESURFACING LIMITS ARE 2 OR MORE MILES IN LENGTH. ROUND UP TO NEXT WHOLE NUMBER. (NO FRACTIONAL OR DECIMAL NUMBERS)	1) LESS THAN 1000' OF RESURFACING ALONG -Y- LINE 2) SUBDIVISION ROADS 3) DEAD END ROADS	
	3	 PLACE INITIALLY AT THE CONSTRUCTION LIMITS AND SPACED 1 MILE APART THEREAFTER. IF NO -Y- LINES EXIST, PLACE 2ND SET 1/2 MILE FROM THE CONSTRUCTION LIMITS AND THEN SPACE 1 MILE THEREAFTER.	WHEN PAVING/CONSTRUCTION ACTIVITIES PROCEED ACROSS AN UNSIGNED -Y- LINE, ADVANCE WARNING PORTABLE SIGNS SHALL BE USED ALONG THE -Y- LINE AS SHOWN BELOW. REMOVE UPON COMPLETION OF WORK.	
	4	 THESE ARE FOR -Y- LINES THAT ARE "THROUGH" ROADWAYS. DEAD END AND SUBDIVISION ROADS ARE NOT "THROUGH" ROADWAYS. INSTALL 500' +/- FROM EACH -Y- LINE APPROACH AS SHOWN ABOVE. FOR MULTIPLE -Y- LINES THAT ARE SEPARATED BY 0.25 MILES OR LESS, TREAT AS A SINGLE UNIT AND INSTALL WITHIN 500' OF EACH APPROACH. A MAXIMUM OF 2 SIGN SETS PER MILE. DO NOT INSTALL WHEN -Y- LINES ARE WITHIN 0.5 MILES FROM "END ROAD WORK" SIGN.	 W20-1 48" X 48"	 W20-7 A 48" X 48"
	5	 PLACE 500' FOLLOWING THE END OF CONSTRUCTION LIMITS.	PLACED 500' IN ADVANCE OF FLAGGER. PLACED 250' IN ADVANCE OF FLAGGER.	

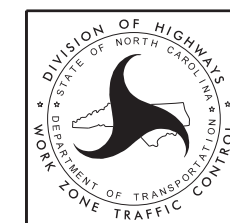

RESURFACING  
ADVANCE WARNING SIGNS  
FOR  
RURAL AND SUBURBAN  
2 LANE ROADWAYS